

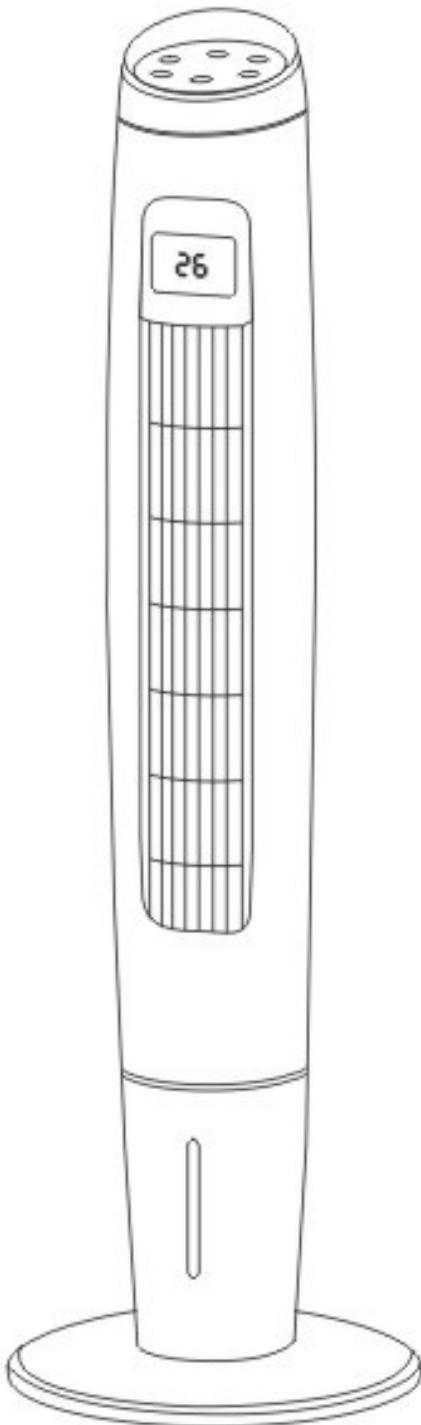

## **Evaporative cooler**

### **Model OT-EC-65**



220-240 V / 50-60 Hz / 65 W  
3,5 l water tank capacity

#### **Introduction**

Thank you for choosing an Ozeanos product.

Please read this manual carefully before using the product.

If you have questions how to use the product, please don't hesitate to contact us.

## Installation and tank filling

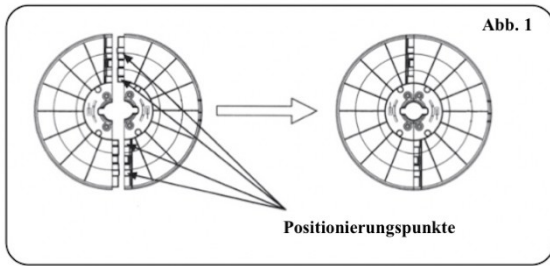

### Installation

1. Take both parts of the socket and merge them as shown on figure 1.

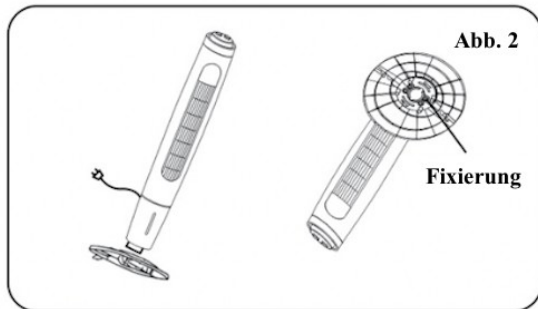

2. Undo the screw from the bottom of the product. Merge the base hole and the screw hole of the product. Now tighten the screw (fig. 2).

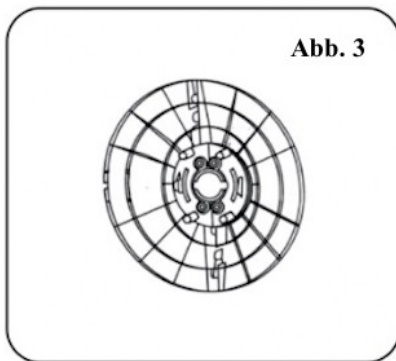

3. If you want to separate the socket, unscrew the base screw and remove the socket (fig. 3).

### Tank filling

Unlock the water tank on the bottom of the back side. Open the water tank cover, fill the tank with water up to the marking „MAX“ and then fix the water tank cover again.

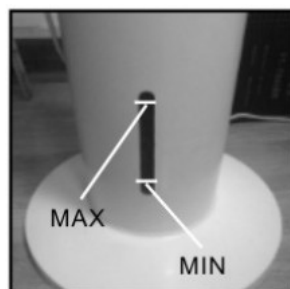

### Hint for improved cooling capacity:

Take coolpacks or fill an ice cube tray with water and put it to a freezer. Take them out when the water is frozen and add the ice cubes or pads to the water tank to improve the cooling capacity.

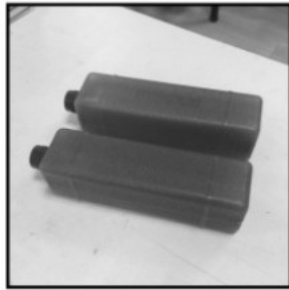
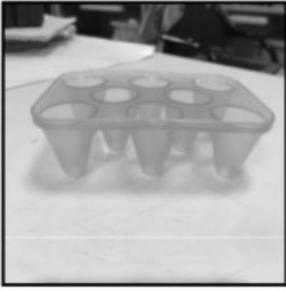

## Starting up

### ON/OFF

- Connect the power cord of the evaporative cooler to a socket. Push the ON/OFF button to turn the device on.

### SPEED

- The evaporative cooler has three power stages: low / medium / high.

### SWING

- Push the SWING button to start the automatic oscillation. Push the button again to stop the oscillation feature.

### COOL/ANION

- Push the COOL button once to increase the cooling capacity. If you use a coolpad, the emanating air may become cooler.
- Double pushing of the button starts the anion feature for air freshening.
- Triple pushing of the button combines the cooling feature with the anion feature.
- Fourfold pushing of the button stops both features.

### TIMER

- The model has a timer for up to 12 hours. Each push of the button increases the timer for one hour. Another push of the button after reaching the maximum stops the timer feature.

### MODE

- The evaporative cooler has three kinds of wind modes: normal / natural / sleep.

## Using the remote control

Insert two batteries. The buttons on the remote control have the same function as the buttons on the control panel. Point the remote control towards the receiver on the device.

## Security notes

1. Do only operate the device using the correct rated voltage (220-240 V).
2. Do not repair the device yourself, let it only be repaired by an authorized technician.
3. Do not operate the device with wet hands to avoid damage.
4. If the power cord is damaged, it must be replaced by the manufacturer, service partner or a similarly qualified person to avoid danger.
5. If you do not use the device, turn it off and pull the plug.
6. Do not insert any objects in air outlets or inlets to avoid damage.
7. Do not use the device close to explosive and flammable gases. Avoid long-term direct sunlight.
8. Do only use the device on a plane surface.
9. Do not use the device outdoors.
10. The filling level of the water tank shall never exceed the „MAX“ marking. During cooling the total filling level of the water tank shall not undercut the „MIN“ marking.
11. Do not lay down the device. If it falls over and water leaks into it, pull the plug first. Then contact the service department.
12. Clean the surface with a wet cloth. Do not use strong detergents or lotions. Do not rinse the device.
13. Do not place the air outlets of the device close to walls or curtains.

## Storage

1. Pull the plug from the socket and let the device cool down properly.
2. Make sure that all parts are clean and dry.

## Environment

Do not dispose of the device in normal household waste. Bring it to a municipal collection point for recycling. That way you can add a positive contribution to protecting the environment.



## Warranty and service

If you need help with problems or any other information, please use our website or contact us or your seller.

Find out about our entire product range on our website.

Ozeanos contact data:

Telephone: +49-2154-95365-30

E-Mail: [support@ozeanos-cl.de](mailto:support@ozeanos-cl.de)

Internet: [www.ozeanos-cl.de](http://www.ozeanos-cl.de)